

PRELIMINARY NOTICE Available For Lease

76,870 SF

Corporate Office Building



26240 Enterprise Way, Lake Forest, California



Pacific Commerce Centre

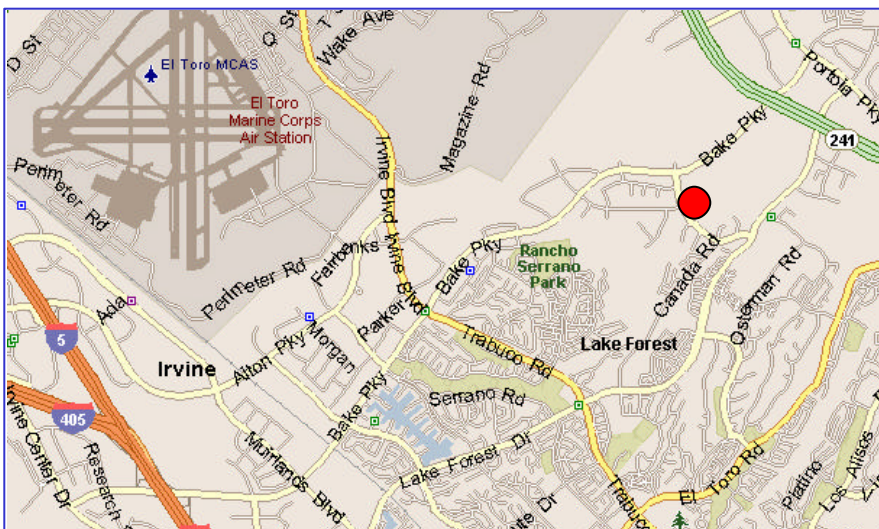

Features

- Located within the Pacific Commerce Centre Business Park
- Divisible from 5,000 to 76,870 SF
- High Image Corner Location
- Elevator Served
- Parking: 4:1,000
- Commence Grading December, 2000
- Commence Construction February, 2001
- Construction Completion Estimated to be August, 2001

Scott Garmon ● Bob Griffith (949) 474-4004



**CUSHMAN &
WAKEFIELD**

See beyond the expected.

No warranty of representation, express or implied, is made as to the accuracy of the information contained herein, and same is submitted subject to errors, omissions, change of price, rental or other conditions, withdrawal without notice, and to any special listing conditions, imposed by our principals

PRELIMINARY NOTICE Available For Lease

26240 Enterprise Way, Lake Forest, California

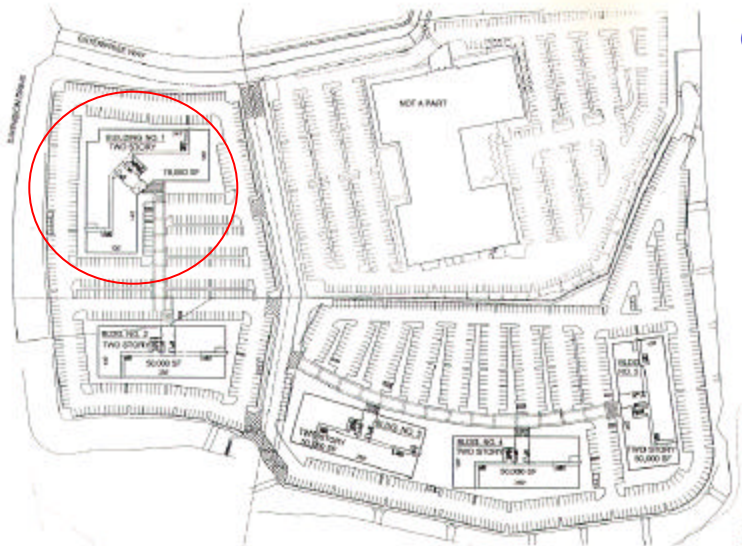
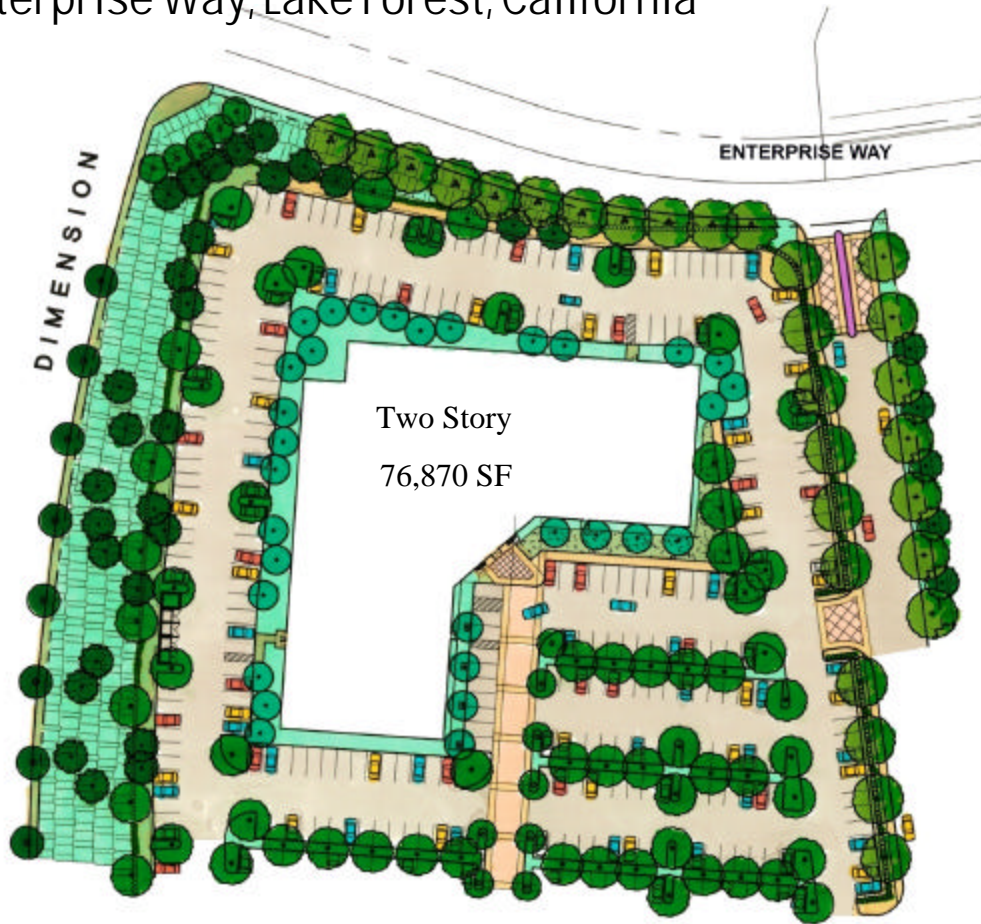

Corporate Neighbors:

- ★ Gateway Computers
- ★ Matsushita Avionics
- ★ Western Digital
- ★ Orange County Register
- ★ Wyle Electronics
- ★ Pacific Mutual



Gale & Wentworth California, L.L.C.

A Development by:



BIXBY LAND COMPANY